

Milestones



Waterfront Brisbane

The proposed \$2.1b Waterfront Brisbane development will transform Brisbane's Eagle Street Pier and surrounds into a premium business and leisure destination.

The project consists of the redevelopment of the existing Eagle Street Pier building and Waterfront Place sites to deliver a new public precinct encompassing the Mary Street Plaza, City Verandah, Creek Street Plaza, enhanced Riverwalk and Eagle Street.

The development will include two premium commercial towers, riverfront dining, retail space and a vastly landscaped public realm, conceptualising a subtropical riverside vista. The development incorporates an elevated podium level above open terraced ground floor plazas which anchor the two commercial towers.

The Eagle Street Pier site works are programmed to commence in 2022 with the new Riverwalk scheduled to open in 2024. The first commercial tower is scheduled for completion in 2026.

RCP is delighted to be a member of the consultant team tasked to deliver this catalyst project, which will contribute to the ongoing success of Brisbane as a globally recognised and competitive world class city. RCP has been engaged by Dexu to provide project management and specialist programming services throughout the design, planning, authority approval and construction phases of the project.

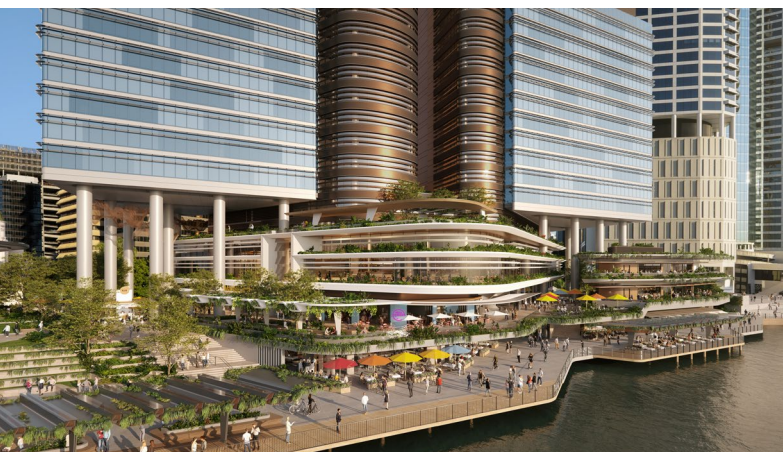

Inside this Issue

Waterfront Brisbane • 83 Pirie Street, Adelaide • JCU Student Accommodation, Townsville • Parkside, Wolli Creek, Sydney • Hutt St Centre Redevelopment, Adelaide • Lido Apartments, Altona, Melbourne • Fisher & Paykel Healthcare Building 4, Auckland



83 Pirie Street, Adelaide

RCP is providing project management and specialist programming services for Cbus Property's proposed 83 Pirie Street development.

The 21 storey scheme, designed by Woods Bagot, involves the construction of a targeted Gold WELL rating A Grade commercial office building comprising approximately 30,000sqm NLA with ancillary car parking, an onsite wellbeing lifestyle centre and 365sqm ground-floor retail.

The building will have flexible floor plates which can be merged to create vertical communities and will be topped with a rooftop terrace.

The development is scheduled for completion in 2022.



JCU Student Accommodation, Townsville

James Cook University is developing new student accommodation to provide a 'social home' for undergraduate students.

The \$54m student accommodation project will provide contemporary, affordable purpose-built accommodation that will encourage community living and will contribute to the university's high quality student experience.

The development will consist of a 7 level building with 403 bedrooms, central self-catered kitchen, external dining bistro, sky lounge and other social common areas.

RCP is performing project management and superintendent's representative services for the project, which is to be delivered under a design and construct agreement.

The date for the opening of the new student accommodation facility is planned for January 2022.





Parkside Wolli Creek, Sydney

The Parkside, Wolli Creek development reached a significant milestone, celebrating the topping out ceremony on the 27th August.

Originally designed by Marchese Partners and detailed by Tesserarch/Vision Group Architects, the project consists of 106 one to three bedroom apartments, across two towers as well as two levels of basement car parking. The project also includes a rooftop kitchen and dining areas, lounges, gym, cinema and communal herb gardens.

RCP was engaged by APH Holding to perform project management and superintendent services for the project.



Hutt St Centre Redevelopment, Adelaide

Hutt St Centre is a charity organisation that offers wellbeing and professional services for up to 3,000 “rough sleepers” and people experiencing homelessness each year. The centre provides meals, showers and laundry facilities, housing support and life skills through education, training and employment services.

The Hutt St Centre site currently occupies two local heritage houses and a larger building adjacent. The project entails a full redevelopment of the centre’s amenities including multipurpose and consultation rooms, offices and computer areas, modern entrance, external courtyard, art room and improved frontage landscaping.

RCP has been engaged to perform project management services for the redevelopment and is overseeing the design development, construction documentation and project construction phases.



Lido Apartments, Altona Melbourne

Positioned in the heart of Altona, Lido presents a choice of 31 architecturally designed apartments crafted to deliver the essence of sea-side living.

The \$12m project consists of the construction of a stylishly modern reinforced concrete multi-level residential development. The building comprises a ground floor with 2 retail premises and office, 37 stacker car parks on the ground floor and traditional car parks on level 1, entry lobby, building services reticulation and four levels of apartments with individual landscaped balconies.

RCP has been appointed by Redleigh Investments Pty Ltd to provide project management and superintendent services for the development, which is scheduled to be completed in December 2021.



Fisher & Paykel Healthcare Building 4, Auckland

RCP New Zealand was engaged by Fisher & Paykel Healthcare (FPH) as the project manager for the design and delivery of the new and innovative \$100m+ building located in East Tamaki, Auckland. FPH is the largest manufacturer of two of the primary respiratory therapies being used to treat patients with COVID-19 in hospitals around the world.

The building incorporates large open plan office space, laboratory and model shop spaces, a controlled air environment manufacturing space, materials warehouse, distribution centre, under-croft carpark and extensive roading with landscaping to complement their existing campus.

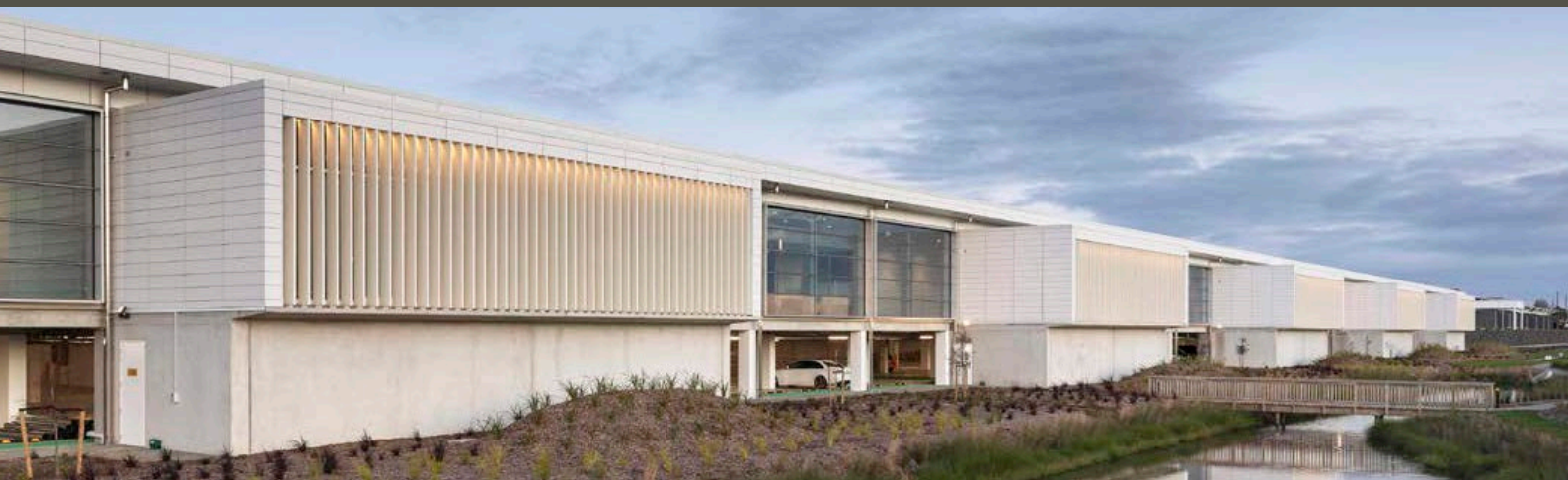

Copyright © 2020
Resource Co-ordination Partnership Pty Ltd (Trading as RCP)
ACN 010 285 757 and its licensors. All rights reserved.
QBCC Licence No. 1147410

 www.linkedin.com/company/rcppaus

 www.instagram.com/rcp_aus

AUSTRALIA

Website www.rcp.net.au
Email rcp@rcp.net.au

Adelaide Tel: +61 8 8205 7000

Brisbane Tel: +61 7 3003 4100

Melbourne Tel: +61 414 584 398

Sydney Tel: +61 2 8234 8000

Townsville Tel: +61 7 4721 0833

NEW ZEALAND

Website www.rcp.co.nz
Email rcp@rcp.co.nz

Auckland Tel: +64 9 379 9250

Christchurch Tel: +64 3 379 4701

Queenstown Tel: +64 3 550 0950

Tauranga Tel: +64 7 579 9250

Wellington Tel: +64 4 473 1850